

PANEL CUT-OUT



PCB LAYOUT

产品类型特性

- 1. AC插座 材质
- 2. 塑胶件 PA66
- 3. 插销 黄铜镀镍
- 4. 端子 黄铜镀锡

- 1. 使用温度范围: $-10^{\circ}\text{C} \pm 70^{\circ}\text{C}$
- 2. 额定值: 2.5A/5A/7A AC 125V 250V AC
- 3. 绝缘电阻: $100\text{M}\Omega$
- 4. 耐电压: 2500V AC
- 5. 接触电阻: $30\text{M}\Omega$
- 6. 寿命: 10000次

结构特性 插拔力: $13.6\text{N} \sim 68\text{N}$

端子强度: 60N

盐雾测试: $35 \pm 2^{\circ}\text{C}$ 24/h

耐环境性能 耐寒性能 $-20 \pm 2^{\circ}\text{C}$ 96/h

耐热性能 $100 \pm 2^{\circ}\text{C}$ 96/h

耐湿性能 $40 \pm 2^{\circ}\text{C}$ 相对湿度90~95% 96/h



東莞市高迪電子有限公司
DONG GUAN GAO DI ELECTRONICS CO., LTD

TOLERANCE UNLESS OTHERWISE STATED:

Up to 5 ± 0.2
Above 5 ~ 15 ± 0.3
Above 15 ~ 30 ± 0.4
Above 30 ~ 50 ± 0.5
Angle $\pm 0.3^{\circ}$

3RD. ANGEL'S

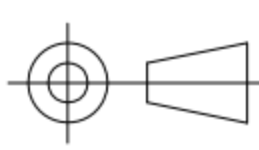

UNITS

MM

DRAWN BY: DATE
Ming Ming Zou 10/31/13

CHECKED BY: DATE
Ning Ning Su 10/31/13

APPROVED BY: DATE
Jia Xiang 10/31/13

| | | | |
|-----------|--------|----------|-----------------|
| MAT'L | | TITLE | SWITCH |
| FINISH | | MODLE | AC POWER SOCKET |
| SCALE | 1:1 | DWG NO. | GD-DB-8-15P9B |
| SHEET NO. | 1 of 1 | PART NO. | |
| | | SIZE | A4 |
| | | VER | R |

| | | | |
|----------|-------------|-------|------|
| ITEM NO. | DESCRIPTION | DRAWN | DATE |
| | | | |